

(150 bar)	12 volt	24 volt
Pump - Motor enhet	115 A	75 A
Magnet (hyd. aggregat)	1,4 A	0,7 A
Magnet (el. slangbr. ventil)	1,5 A	0,75 A
Solenoid	1,8 A	0,9 A
Ledningsarea:		
Manöverkabel	1,5 mm <sup>2</sup>	1,5 mm <sup>2</sup>
Matarledning 0-8 m	35 mm <sup>2</sup>	35 mm <sup>2</sup>
Matarledning 8-15 m	35 mm <sup>2</sup>	35 mm <sup>2</sup>
Matarledning <15 m	-	35 mm <sup>2</sup>
Strömkälla:		
Min. kapacitet	140 Ah	110 Ah
Min. spänning	9 Volt	18 Volt

Belastningsdiagram

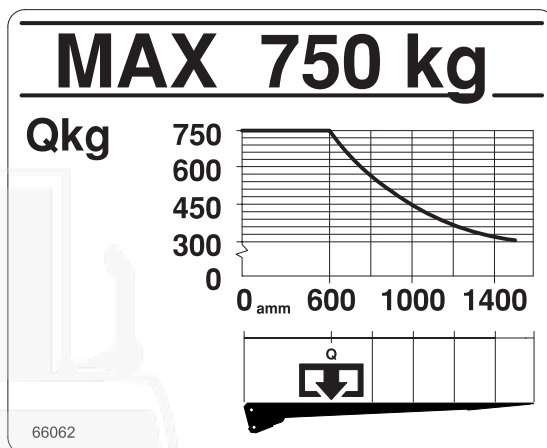

Inbyggnadsmått (mm)

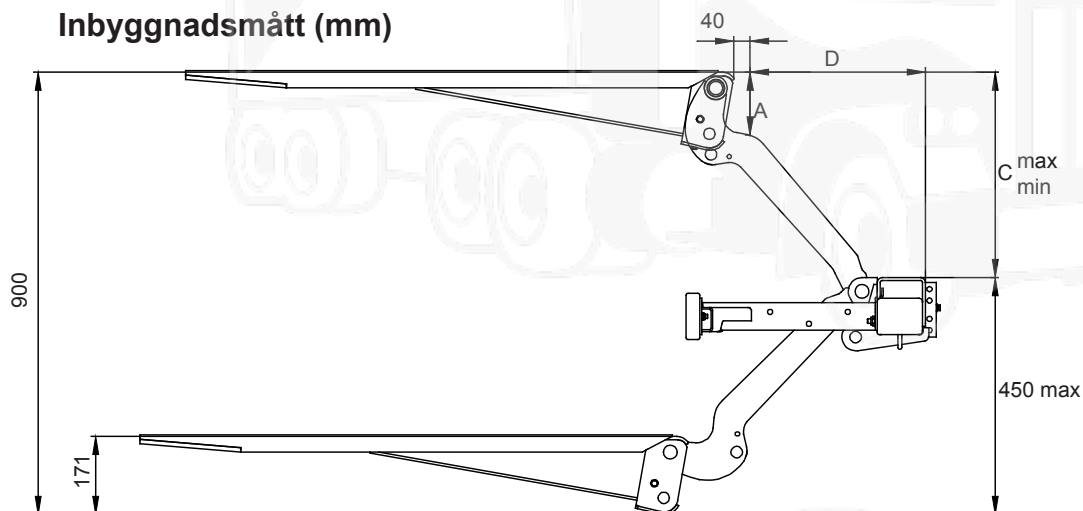

C	A	D
450	136	384
400	126	444
350	115	490
300	104	526
250	96	554

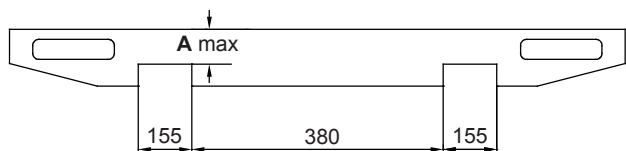
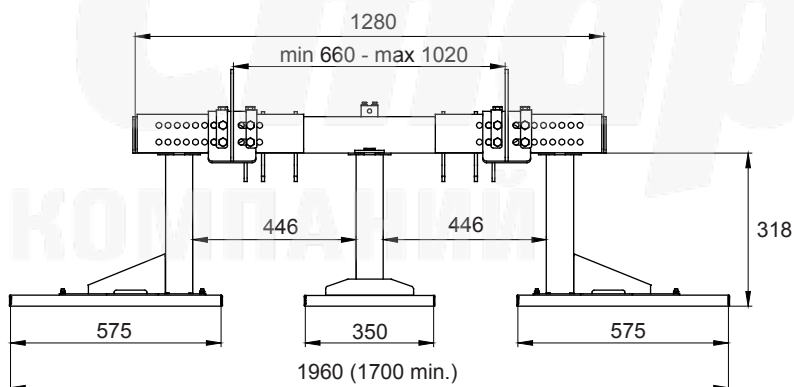
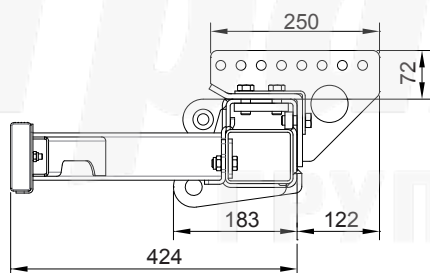

**ZEPRO**



**Трак Стар**  
ГРУППА КОМПАНИЙ